

Standard Connectors

Panel Connectors

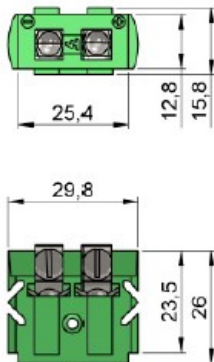

Type K
Type J
Type T
Type B
Type R/S
Type E
Type N

IEC	ANSI
 green	 yellow
 black	 black
 brown	 blue
 grey	 grey
 orange	 green
 purple	 purple
 pink	 orange

Colour Coding to DIN EN 60584

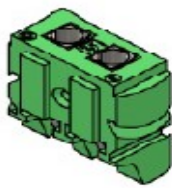

Basic Panel Insert
Back mounted with
assembly set

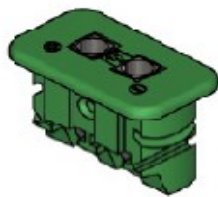

Rectangular Insert short
Front mounted with
screws

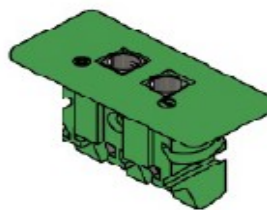

Rectangular Insert long
Front mounted with
assembly or spring set

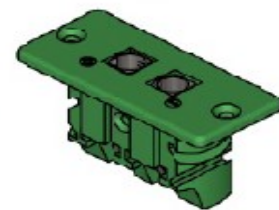

Rectangular Insert long
Front mounted with
assembly or spring set

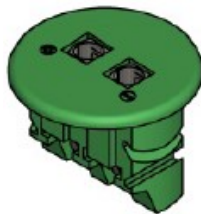

Round Insert
Back mounted with
brass nut and spring set

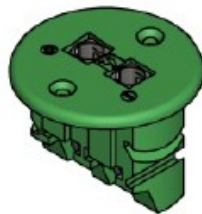

Round Insert
Front mounted with
screws

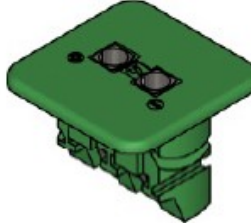

Square Insert
Back mounted with
brass nut and spring set

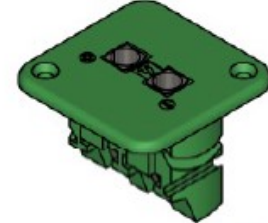

Square Insert
Front mounted with
screws

Specification

Body:	Thermoplastic
Contacts:	Class 1 material, reverse polarity protected <ul style="list-style-type: none"> • Plug with coded flat contacts • Socket with spring loaded contacts
Terminal:	Captive screw and plate
Temperature Rating:	Up to 250°C
Standard:	EN50212

Thermocouple Panels

Standard Connector Panel Fasteners

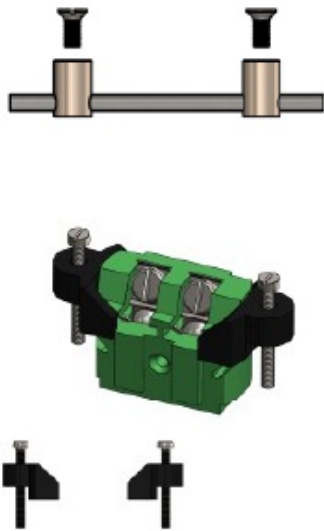

Assembly Set for Panel Inserts

Material : Stainless Steel

Arrangements:	Blacks	Rods
1 Panel	2 pcs	1 pc 30.0mm
6 Panel	3 pcs	1 pc 115.0mm
12 Panel	6 pcs	1 pc 225.0mm
24 Panel	9 pcs	2 pcs 225.0mm each
30 Panel	12pcs	2 pcs 285.0mm each

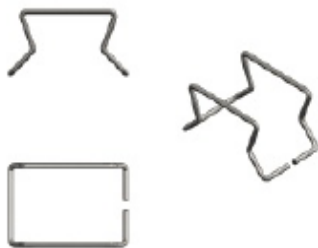

Back Panel Spring Mount

Material: Brass

Thickness: 2.5mm



Brass Nut for Panel Mount

Material: Brass

Thread: M18 x 1.5